

Rev No.	Change Order	Date	Note	Prepared by	Approved by
04	---	94.02.19	Adding static & dynamic loading	Shiroki	Genoel

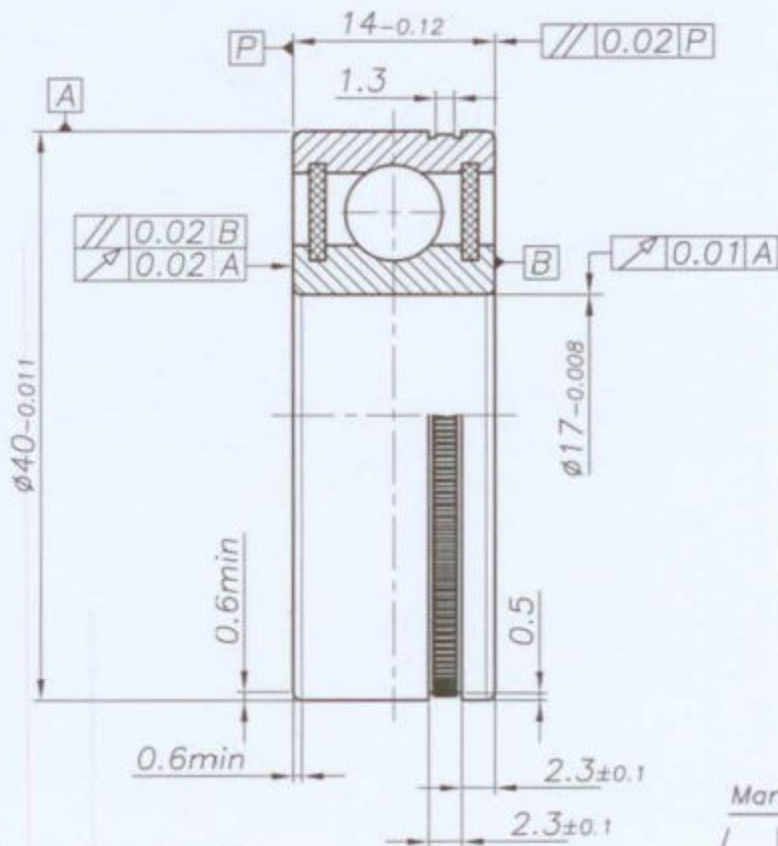

- Basic load rating : $C_r=10500N$
 $C_{or}=520GN$
- Marking : As drawing
- Noise ≤ 36 dB
- Working temperature $-40^\circ C$ to $+120^\circ C$
- Working speed 2000-8000 RPM
- Radial clearance 0.01-0.02 mm
- Grease weight 0.79-1.10 gr
- knurled stripe on outer ring surface:
knurled diameter 39.8 ± 0.1
Number of teeth 152
Tooth depth 0.25 min
- All specification are obtained from bearing DIN625 6203 B14-2RZ
except are shown in drawing

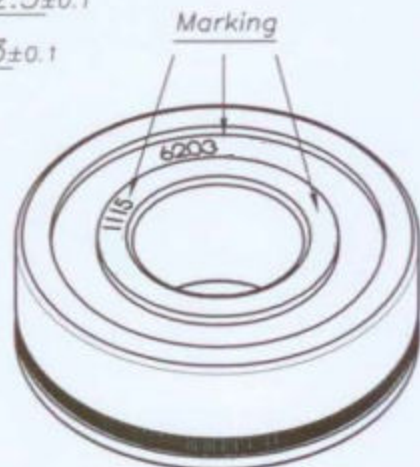

$\sqrt{Ra0.8}$